

01/2014

Mod: C4.3B/PM

Production code: 10702719-0-0-0 (02)



Diamond
catering equipment

Model / Modèle / Modell**Line / Ligne / Serie****Minicold ISO 80****DIAMOND**

- 1 PANEL OF THE FRAME AND DOOR/ PANNEAU DU CERCEAU ET LA PORTE/WAND DES RAHMENS UND DER TÜR
2 ACCESSORIES/ ACCESSOIRES/ ZUBEHÖRE

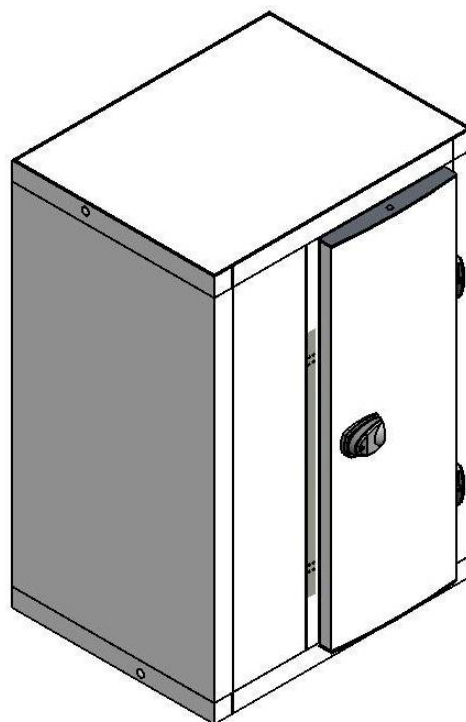

80 Panels DIAMOND Cold Room
Panneaux 80 Chambre Froid DIAMOND
80 Wände DIAMOND Kühlzelle



PANEL OF THE FRAME AND DOOR/ PANNEAU DU CERCEAU ET LA PORTE/WAND DES RAHMENS UND DER TÜR

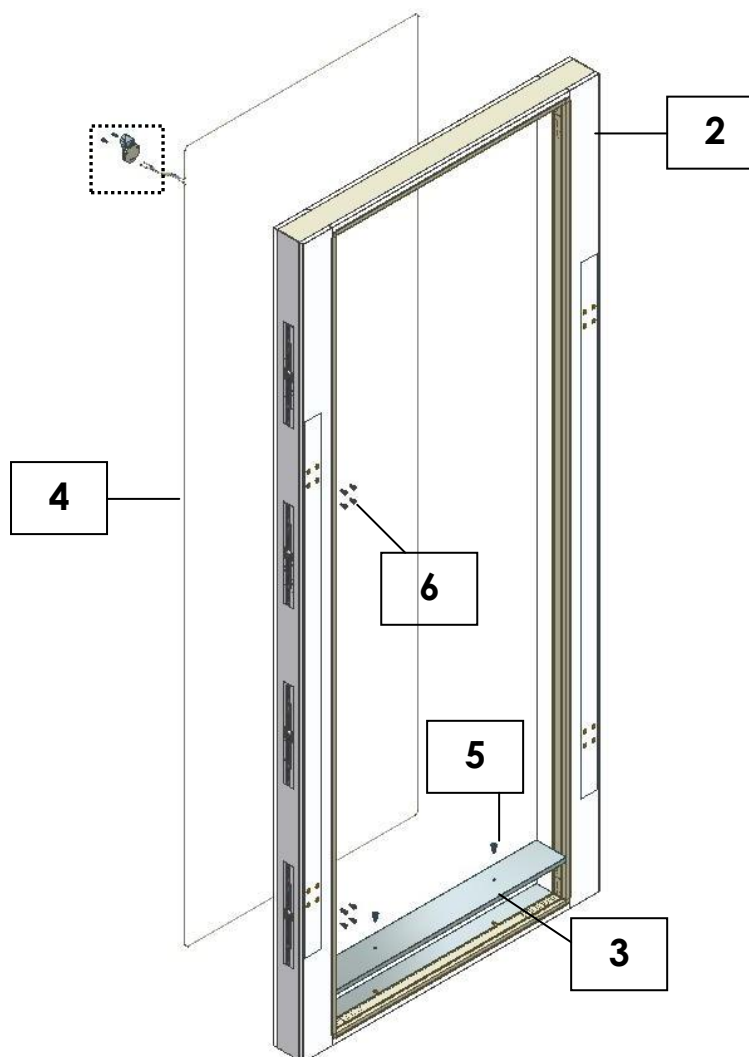
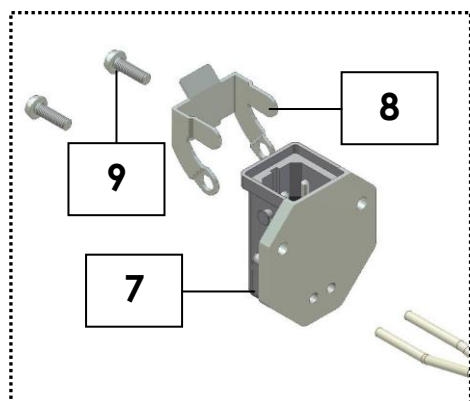

PANEL OF THE FRAME AND DOOR/ PANNEAU DU CERCEAU ET LA PORTE/WAND DES RAHMENS UND DER TÜR

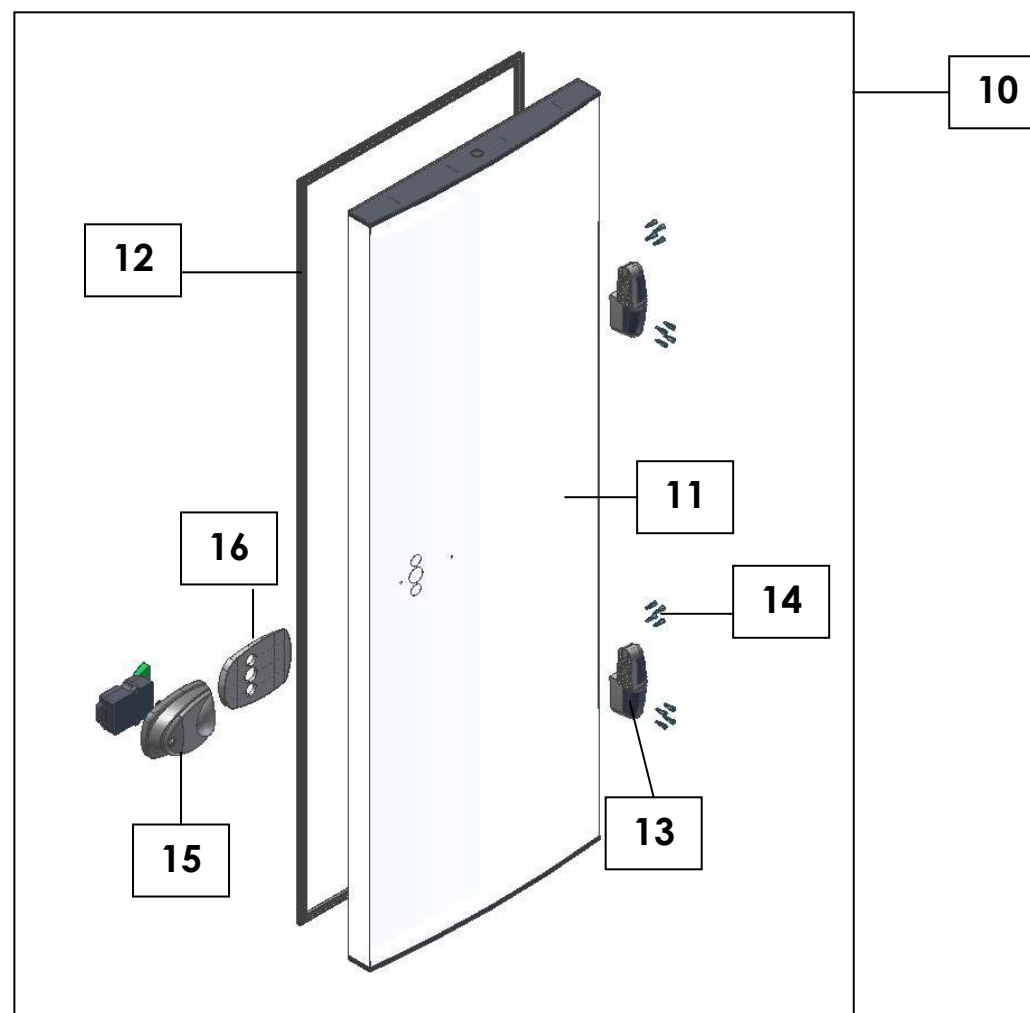

PANEL OF THE FRAME AND DOOR/ PANNEAU DU CERCEAU ET LA PORTE/WAND DES RAHMENS UND DER TÜR

PARTS LISTS / LISTES DES PIÈCES DÉTACHÉS / EINZELTEILLISTE

Minicold ISO
80

	Number Nombre Zahl	Code Code Code	Cold Room Code Chambre Froid Code Kühlzelle Code	No of Parts N. Pièces Nr Stücke
COMPLETE PANEL OF THE DOOR FRAME LOW COLD ROOM PANNEAU COMPLET DU CERCEAU DE LA PORTE CHAMBRE FROIDE BASSE KOMPLETTER WAND DES RAHMENS DER TÜR KLEINE KÜHLZELLE	1	61602351	10702701 10702702	1
		61602353	10702706...26	1
PANEL OF THE DOOR FRAME LOW COLD ROOM PANNEAU DU CERCEAU DE LA PORTE CHAMBRE FROIDE BASSE WAND DES RAHMENS DER TÜR KLEINE KÜHLZELLE	2	61602221	10702701 10702702	1
		61602228	10702706...26	1
PROTECTION OF THE DOOR FRAME PANEL PROTECTION DU PANNEAU DU CERCEAU DE LA PORTE SCHUTZ DES WANDS DES RAHMENS VON DER TÜR	3	61602263	10702701 10702702	1
		61602264	10702706...26	1
RESISTANCE FOR DOOR RESISTANCE POUR PORTE VERSTÄRKUNG FÜR TÜR	4	45101027	10702701 10702702	1
		45101028	10702706...26	1
M5x17 INOX FILLISTER HEAD SCREW VIS A TETE RONDE M5x17 INOX LINSENENKOPFSCHRAUBEN M5x17 INOX	5	44408001	10702701...26	2

PARTS LISTS / LISTES DES PIÈCES DÉTACHÉS / EINZELTEILLISTE

Minicold ISO
80

	Number Nombre Zahl	Code Code Code	Cold Room Code Chambre Froid Code Kühlzelle Code	No of Parts N. Pièces Nr Stücke
SCREW CAP FOR A 6 MM HEXAGONAL HOLE CACHE A TROU SIX PANS 6 MM KUNSTSTOPFEN FÜR LOCH 6 MM SECHSKANT	6	42601068	10702701...26	8
CONNECTOR OF MALE PANEL STASAP 2B CONNECTEUR DE PANNEAU MÂLE STASAP 2B VERBINDUNGSSTÜCK DER VERKLEIDUNG STASAP 2B	7	43601003	10702701...26	1
STASI2 CONNECTOR BRAKE FREIN DE CONNECTEUR STASI2 VERBINDUNGSSTÜCK-BREMSE STASI2	8	43601005	10702701...26	1
SCREW CYLINDRICAL HEAD PHILLIPS M3 x 10 STAINLESS STEEL VIS À TÊTE CYLINDRIQUE PHILLIPS M3 x10 INOX ZYLINDERSCHRAUBE PHILLIPS M3 x10 EDELSTAHL	9	44402013	10702701...26	2
COMPLETE DOOR PORTE COMPLÈTE KOMPLETT TÜR	10	61601692	10702701 10702702	1
		61601694	10702706...26	1
DOOR WITHOUT MAGNETIC GASKET PORTE SANS JOINT MAGNÉTIQUE TÜR OHNE MAGNETISCHES VERSCHLUSSDICHTUNGSGUMMI	11	61601693	10702701 10702702	1
		61601695	10702706...26	1

PARTS LISTS / LISTES DES PIÈCES DÉTACHÉS / EINZELTEILLISTE

Minicold ISO
80

	Number Nombre Zahl	Code Code Code	Cold Room Code Chambre Froid Code Kühlzelle Code	No of Parts N. Pièces Nr Stücke
MAGNETIC GASKET JOINT MAGNÉTIQUE MAGNETISCHES VERSCHLUSSDICHTUNGSGUMMI	12	41801049	10702701 10702702	1
		41801050	10702706...26	1
DOOR HINGE CHARNIÈRE DE LA PORTE SCHARNIER DER TÜR	13	46202001	10702701...26	2
M6 x 25 ZINC-COATED HEXAGONAL SCREW VIS A TETE HEXAGONALE M6 x 25 ZINGUEE VERZINKT SECHSKANTSCHRAUBEN M6 x 25	14	44401003	10702701...26	16
DOOR LOCK SERRURE DE LA PORTE VERSCHLUSS DER TÜR	15	41901003	10702701...26	1
EQUALIZING OF THE LOCK OF THE DOOR COMPENSATEUR DE LA SERRURE DE LA PORTE KOMPENSATOR DER VERSCHLUSS DER TÜR	16	46202005	10702701...26	1

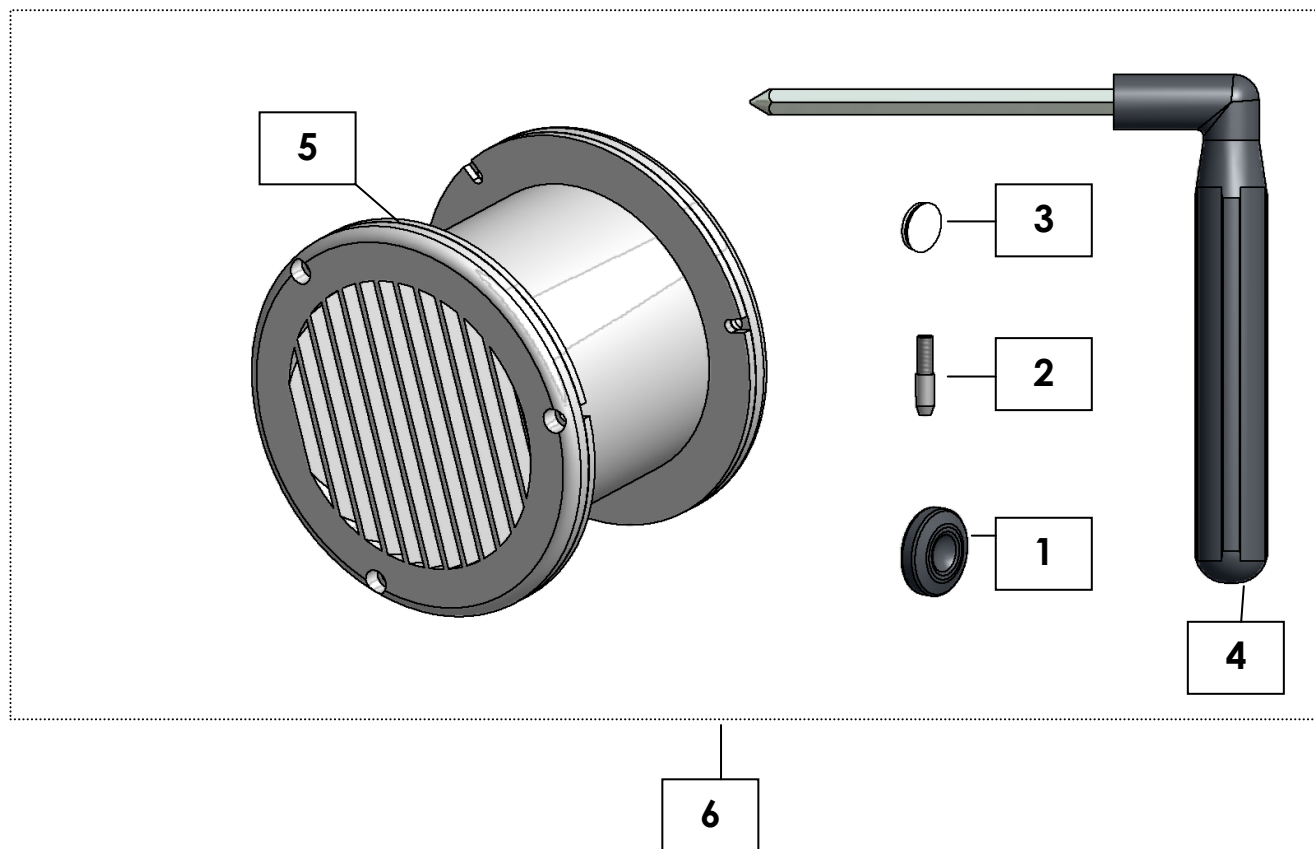
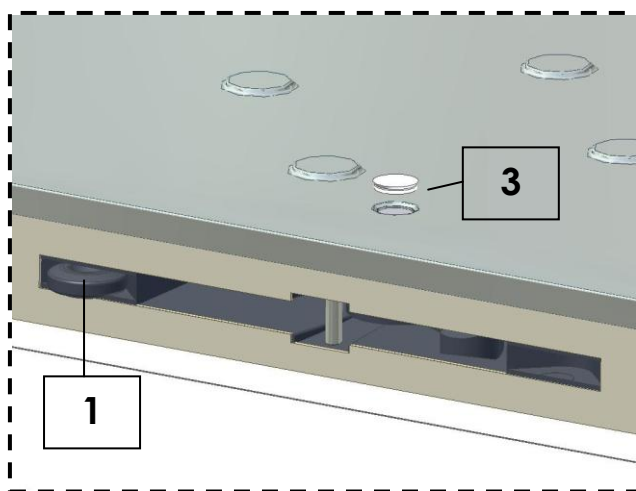
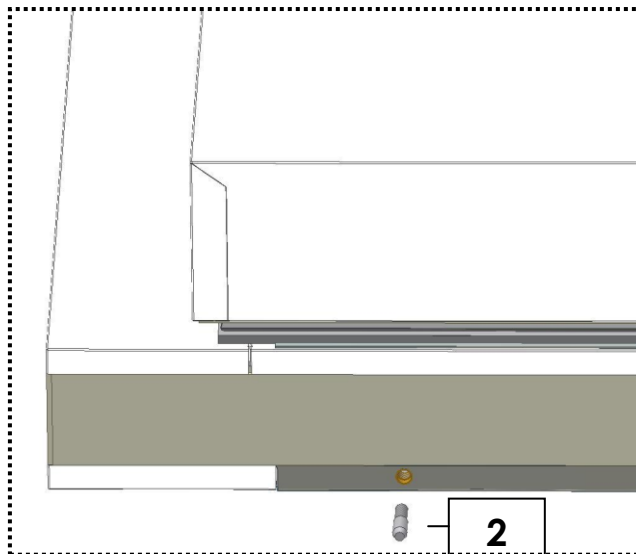

ACCESSORIES / ACCESSOIRES / ZUBEHÖRE

PARTS LISTS / LISTES DES PIÈCES DÉTACHÉS / EINZELTEILLISTE

Minicold ISO
80

	Number Nombre Zahl	Code Code Code	Cold Room Code Chambre Froid Code Kühlzelle Code	No of Parts N. Pièces Nr Stücke
ALIGNMENT PART PIÈCE D'ALIGNEMENT AUSRICHTUNGS-TEIL	1	46201005	10702701	44
			10702702	62
			10702706	53
			10702707	68
			10702708	75
			10702709	82
			10702710	93
			10702713	62
			10702714	82
			10702715	89
			10702716	99
			10702717	108
			10702718	119
			10702719	62
			10702720	82
			10702721	108
			10702722	108
10702723	119			
10702725	119			
10702726	133			
IRON STUD-PIN RED. 5,8X25 - ZINC. BOULON EN FER RED. 5,8X25 - ZINC. SCHARUBE AUS EISEN RED. 5,8X25 - ZINC.	2	45907013	10702701	2
			10702702	
			10702706...26	0

PARTS LISTS / LISTES DES PIÈCES DÉTACHÉS / EINZELTEILLISTE

Minicold ISO
80

	Number Nombre Zahl	Code Code Code	Cold Room Code Chambre Froid Code Kühlzelle Code	No of Parts N. Pièces Nr Stücke
COVER STAMPING LOCKS COUVERTURE ESTAMPAGE SERRURES ABDECKUNG, DIE VERSCHLÜSSE STEMPELT	3	42601029	10702701	48
			10702702	80
			10702706	65
			10702707	94
			10702708	101
			10702709	114
			10702710	130
			10702713	80
			10702714	114
			10702715	121
			10702716	138
			10702717	150
			10702718	166
			10702719	80
			10702720	114
			10702721	150
10702722	150			
10702723	166			
10702725	166			
10702726	188			
COATED HEXAGONAL KEY CLÉ HEXAGONALE REVÊTUE ÜBERZOGENER SECHSECKIGER SCHLÜSSEL	4	45903003	10702701...26	1
VALVE	5	46202010	10702701...26	1

PARTS LISTS / LISTES DES PIÈCES DÉTACHÉS / EINZELTEILLISTE

Minicold ISO
80

	Number Nombre Zahl	Code Code Code	Cold Room Code Chambre Froid Code Kühlzelle Code	No of Parts N. Pièces Nr Stücke
SET OF ACCESSORIES ASSORTIMENT D'ACCÉSSOIRES ZUBEHÖRE	6	61601561	10702701	1
		61601563	10702702	
		61601562	10702706	
		61601568	10702707	
		61601569	10702708	
		61601571	10702709	
		61601573	10702710	
		61601564	10702713	
		61601571	10702714	
		61601572	10702715	
		61601574	10702716	
		61601575	10702717	
		61601576	10702718	
		61601564	10702719	
		61601571	10702720	
		61601575	10702721	
		61601575	10702722	
		61601576	10702723	
61601576	10702725			
61601577	10702726			

PARTS LISTS / LISTES DES PIÈCES DÉTACHÉS / EINZELTEILLISTE

Minicold ISO
80

C11.6B/PM

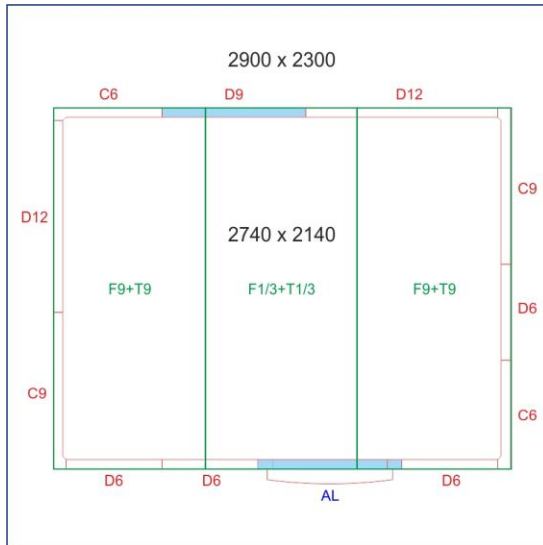

Panel ID				
Legend	Description	Prod. code	Dimensions	Qty
AL	Door with frame	61602353	900 x 1910 x 80	1
C6	Corner	61602146	700 x 1910 x 80	2
C9	Corner	61602148	1000 x 1910 x 80	2
D6	Side	61602134	600 x 1910 x 80	4
D9	Side	61602135	900 x 1910 x 80	1
D12	Side	61602136	1200 x 1910 x 80	2
F1/3	Floor	61602345	900 x 2300 x 80	1
F9	Floor	61602321	1000 x 2300 x 80	2
T1/3	Ceiling	61602255	900 x 2300 x 80	1
T9	Ceiling	61602247	1000 x 2300 x 80	2

C9.0A/PM

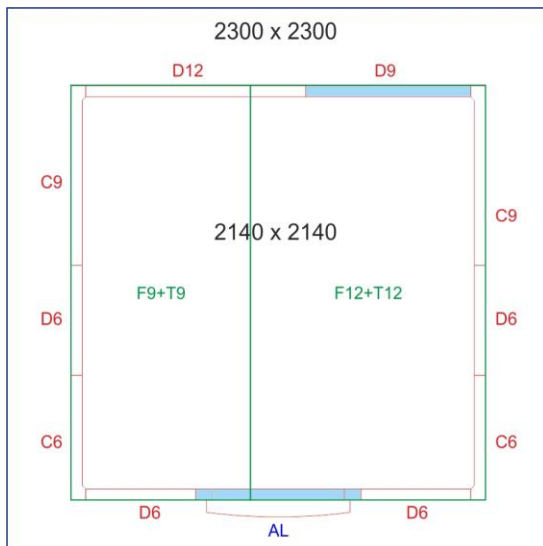

Panel ID				
Legend	Description	Prod. code	Dimensions	Qty
AL	Door with frame	61602353	900 x 1910 x 80	1
C6	Corner	61602146	700 x 1910 x 80	2
C9	Corner	61602148	1000 x 1910 x 80	2
D6	Side	61602134	600 x 1910 x 80	4
D9	Side	61602135	900 x 1910 x 80	1
D12	Side	61602136	1200 x 1910 x 80	1
F9	Floor	61602321	1000 x 2300 x 80	1
F12	Floor	61602322	1300 x 2300 x 80	1
T9	Ceiling	61602247	1000 x 2300 x 80	1
T12	Ceiling	61602248	1300 x 2300 x 80	1

C8.0A/PM

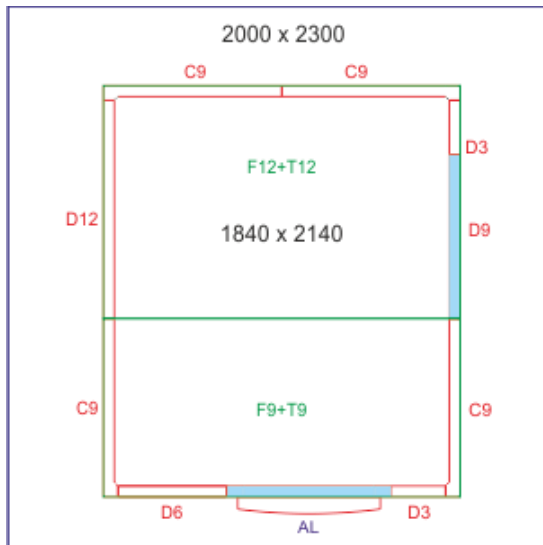

Panel ID				
Legend	Description	Prod. code	Dimensions	Qty
AL	Door with frame	61602353	900 x 1910 x 80	1
C9	Corner	61602148	1000 x 1910 x 80	4
D3	Side	61602132	300 x 1910 x 80	2
D6	Side	61602134	600 x 1910 x 80	1
D9	Side	61602135	900 x 1910 x 80	1
D12	Side	61602136	1200 x 1910 x 80	1
F9	Floor	61602318	1000 x 2000 x 80	1
F12	Floor	61602423	1300 x 2000 x 80	1
T9	Ceiling	61602244	1000 x 2000 x 80	1
T12	Ceiling	61602422	1300 x 2000 x 80	1

C6.7B/PM

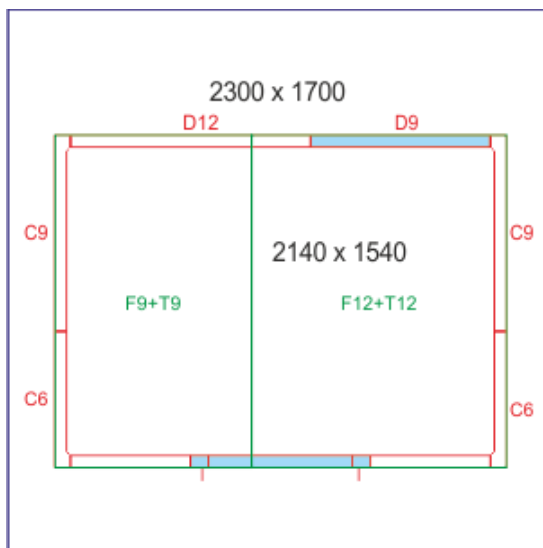

Panel ID				
Legend	Description	Prod. code	Dimensions	Qty
AL	Door with frame	61602353	900 x 1910 x 80	1
C6	Corner	61602146	700 x 1910 x 80	2
C9	Corner	61602148	1000 x 1910 x 80	2
D6	Side	61602134	600 x 1910 x 80	2
D9	Side	61602135	900 x 1910 x 80	1
D12	Side	61602136	1200 x 1910 x 80	1
F9	Floor	61602241	1000 x 1700 x 80	1
F12	Floor	61602292	1300 x 1700 x 80	1
T9	Ceiling	61602315	1000 x 1700 x 80	1
T12	Ceiling	61602414	1300 x 1700 x 80	1

C5.9B/PM

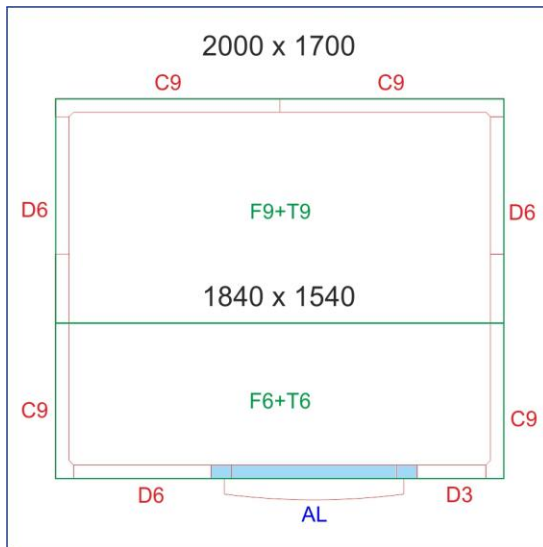

Panel ID				
Legend	Description	Prod. code	Dimensions	Qty
AL	Door with frame	61602353	900 x 1910 x 80	1
C9	Corner	61602148	1000 x 1910 x 80	4
D3	Side	61602132	300 x 1910 x 80	1
D6	Side	61602134	600 x 1910 x 80	3
F6	Floor	61602317	700 x 2000 x 80	1
F9	Floor	61602318	1000 x 2000 x 80	1
T6	Ceiling	61602242	700 x 2000 x 80	1
T9	Ceiling	61602244	1000 x 2000 x 80	1

C5.0A/PM

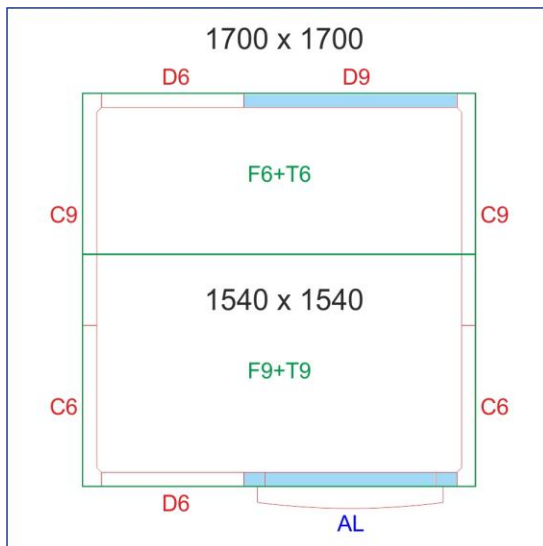

Panel ID				
Legend	Description	Prod. code	Dimensions	Qty
AL	Door with frame	61602353	900 x 1910 x 80	1
C6	Corner	61602146	700 x 1910 x 80	2
C9	Corner	61602148	1000 x 1910 x 80	2
D6	Side	61602134	600 x 1910 x 80	2
D9	Side	61602135	900 x 1910 x 80	1
F6	Floor	61602314	700 x 1700 x 80	1
F9	Floor	61602315	1000 x 1700 x 80	1
T6	Ceiling	61602239	700 x 1700 x 80	1
T9	Ceiling	61602241	1000 x 1700 x 80	1

C5.5B/PM

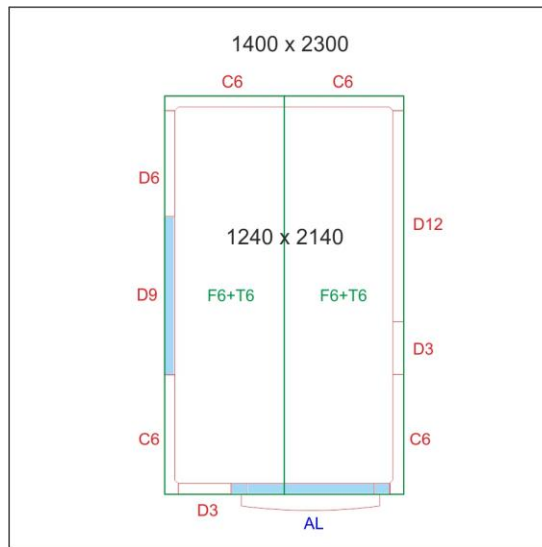

Panel ID				
Legend	Description	Prod. code	Dimensions	Qty
AL	Door with frame	61602353	900 x 1910 x 80	1
C6	Corner	61602146	700 x 1910 x 80	4
D3	Side	61602132	300 x 1910 x 80	2
D6	Side	61602134	600 x 1910 x 80	1
D9	Side	61602135	900 x 1910 x 80	1
D12	Side	61602136	1200 x 1910 x 80	1
F6	Floor	61602320	700 x 2300 x 80	2
T6	Ceiling	61602245	700 x 2300 x 80	2

C4.8B/PM

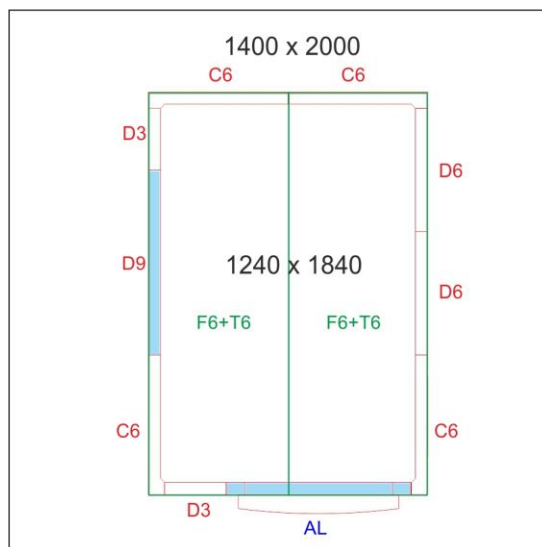

Panel ID				
Legend	Description	Prod. code	Dimensions	Qty
AL	Door with frame	61602353	900 x 1910 x 80	1
C6	Corner	61602146	700 x 1910 x 80	4
D3	Side	61602132	300 x 1910 x 80	2
D6	Side	61602134	600 x 1910 x 80	2
D9	Side	61602135	900 x 1910 x 80	1
F6	Floor	61602317	700 x 2000 x 80	2
T6	Ceiling	61602242	700 x 2000 x 80	2

PARTS LISTS / LISTES DES PIÈCES DÉTACHÉS / EINZELTEILLISTE

Minicold ISO
80

C4.0B/PM

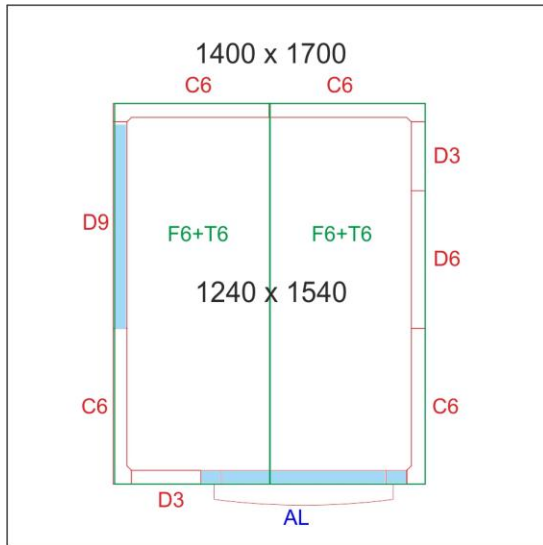

Panel ID				
Legend	Description	Prod. code	Dimensions	Qty
AL	Door with frame	61602353	900 x 1910 x 80	1
C6	Corner	61602146	600 x 1910 x 80	4
D3	Side	61602132	300 x 1910 x 80	2
D6	Side	61602134	600 x 1910 x 80	1
D9	Side	61602135	900 x 1910 x 80	1
F6	Floor	61602314	700 x 1700 x 80	2
T6	Ceiling	61602239	700 x 1700 x 80	2

C3.5A/PM

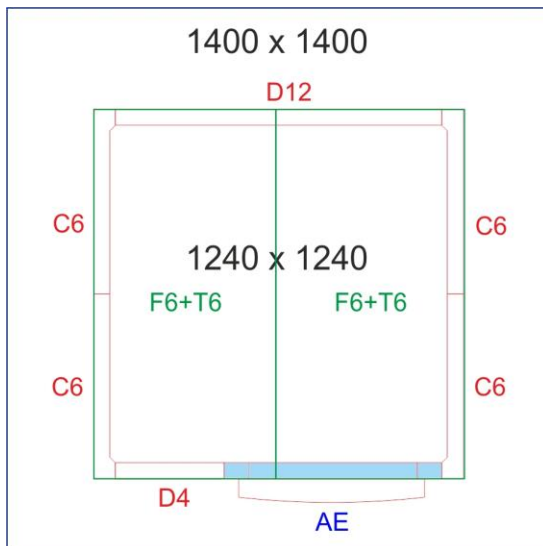

Panel ID				
Legend	Description	Prod. code	Dimensions	Qty
AE	Door with frame	61602351	800 x 1910 x 80	1
C6	Corner	61602146	700 x 1910 x 80	4
D4	Side	61602133	400 x 1910 x 80	1
D12	Side	61602137	1200 x 1910 x 80	1
F6	Floor	61602307	700 x 1400 x 80	2
T6	Ceiling	61602236	1400 x 700 x 80	2

PARTS LISTS / LISTES DES PIÈCES DÉTACHÉS / EINZELTEILLISTE

Minicold ISO
80

C4.3B/PM

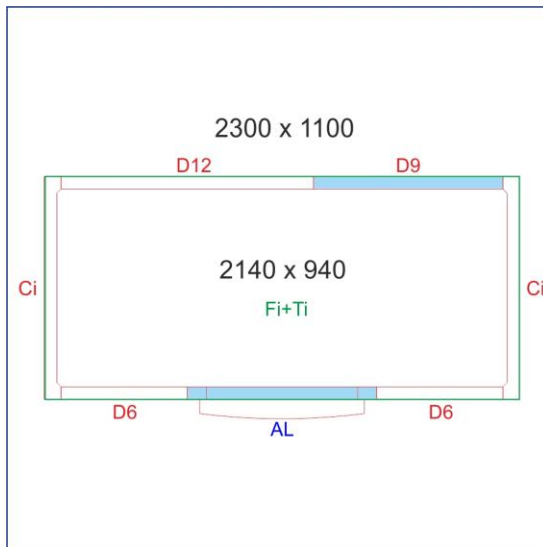

Panel ID				
Legend	Description	Prod. code	Dimensions	Qty
AL	Door with frame	61602353	900 x 1910 x 80	1
Ci	Corner	61602144	1100 x 1910 x 80	2
D6	Side	61602134	600 x 1910 x 80	2
D9	Side	61602135	900 x 1910 x 80	1
D12	Side	61602136	1200 x 1910 x 80	1
Fi	Floor	61602305	2300 x 1100 x 80	1
Ti	Ceiling	61602235	2300 x 1100 x 80	1

C3.7B/PM

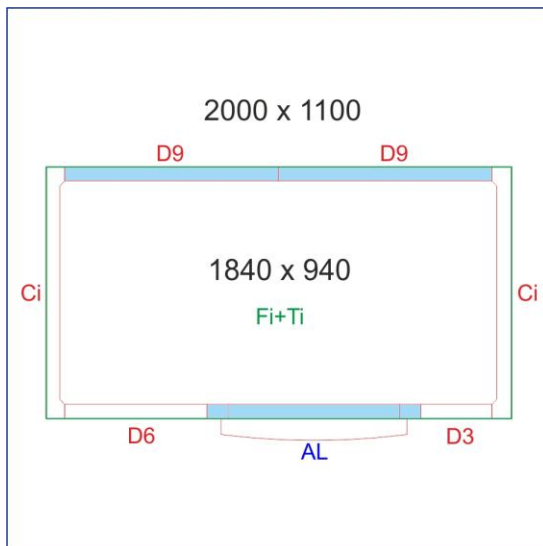

Panel ID				
Legend	Description	Prod. code	Dimensions	Qty
AL	Door with frame	61602353	900 x 1910 x 80	1
Ci	Corner	61602144	1100 x 1910 x 80	2
D3	Side	61602132	300 x 1910 x 80	1
D6	Side	61602134	600 x 1910 x 80	1
D9	Side	61602135	900 x 1910 x 80	2
Fi	Floor	61602303	2000 x 1100 x 80	1
Ti	Ceiling	61602234	2000 x 1100 x 80	1

PARTS LISTS / LISTES DES PIÈCES DÉTACHÉS / EINZELTEILLISTE

Minicold ISO
80

C3.1B/PM

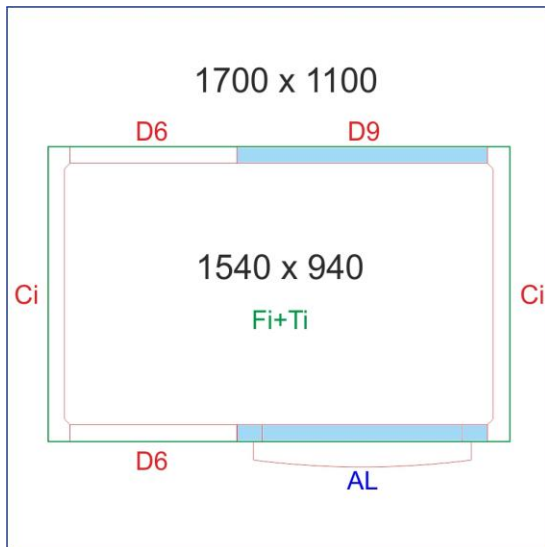

Panel ID				
Legend	Description	Prod. code	Dimensions	Qty
AL	Door with frame	61602353	900 x 1910 x 80	1
Ci	Corner	61602144	1100 x 1910 x 80	2
D6	Side	61602134	600 x 1910 x 80	2
D9	Side	61602135	900 x 1910 x 80	1
Fi	Floor	61602301	1700 x 1100 x 80	1
Ti	Ceiling	61602233	1700 x 1100 x 80	1

C2.6B/PM

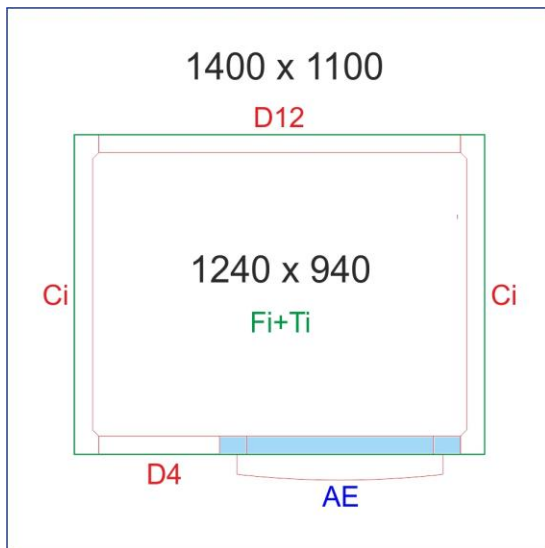

Panel ID				
Legend	Description	Prod. code	Dimensions	Qty
AE	Door with frame	61602351	800 x 1910 x 80	1
Ci	Corner	61602144	1100 x 1910 x 80	2
D4	Side	61602133	400 x 1910 x 80	1
D12	Side	61602137	1200 x 1910 x 80	1
Fi	Floor	61602297	1400 x 1100 x 80	1
Ti	Ceiling	61602232	1400 x 1100 x 80	1

PARTS LISTS / LISTES DES PIÈCES DÉTACHÉS / EINZELTEILLISTE

Minicold ISO
80

C6.5B/PM

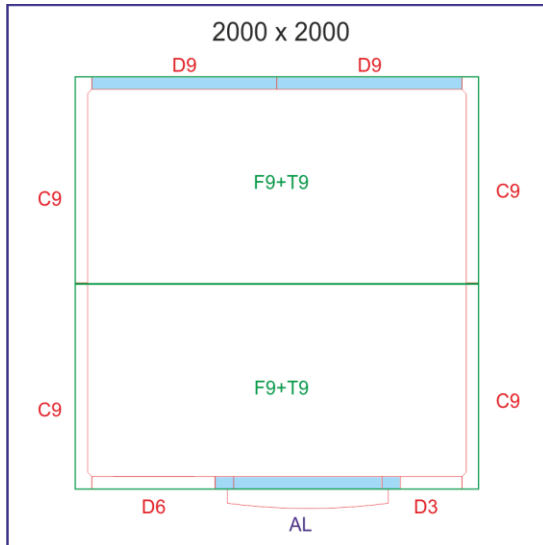

Panel ID				
Legend	Description	Prod. code	Dimensions	Qty
AL	Door with frame	61602353	900 x 1910 x 80	1
C9	Corner	61602148	900 x 1910 x 80	4
D3	Side	61602132	300 x 1910 x 80	1
D6	Side	61602134	600 x 1910 x 80	1
D9	Side	61602135	900 x 1910 x 80	2
F9	Floor	61602318	2000 x 1000 x 80	2
T9	Ceiling	61602244	2000 x 1000 x 80	2

C10.1A/PM

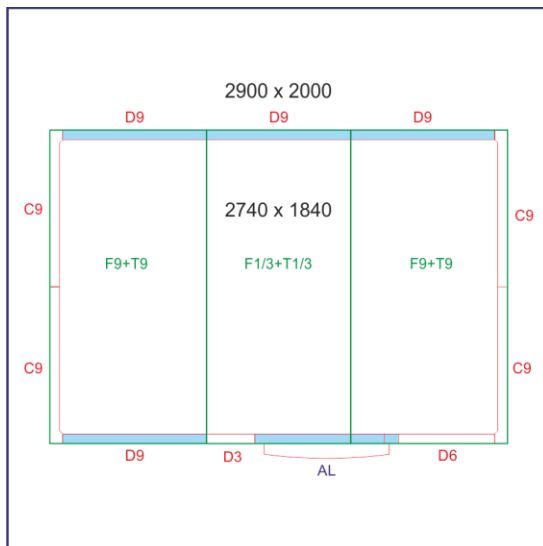

Panel ID				
Legend	Description	Prod. code	Dimensions	Qty
AL	Door with frame	61602353	900 x 1910 x 80	1
C9	Corner	61602148	1000 x 1910 x 80	4
D3	Side	61602132	300 x 1910 x 80	1
D6	Side	61602134	600 x 1910 x 80	1
D9	Side	61602135	900 x 1910 x 80	4
F9	Floor	61602318	2000 x 1000 x 80	2
F1/3	Floor	61602343	2000 x 1000 x 80	1
T9	Ceiling	61602244	2000 x 1000 x 80	2
T1/3	Ceiling	61602254	2000 x 1000 x 80	1

C8.9A/PM

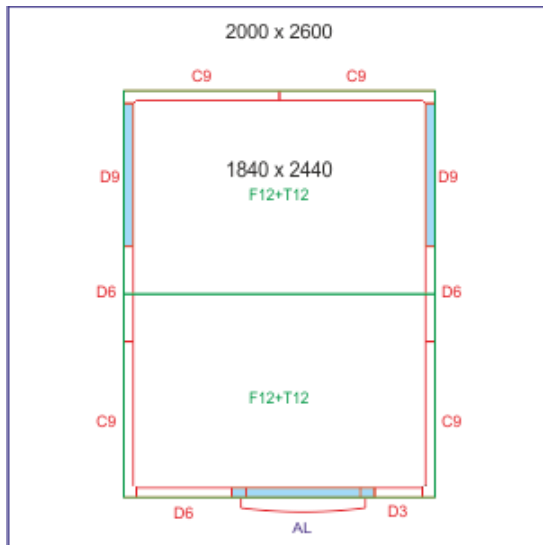

Panel ID				
Legend	Description	Prod. code	Dimensions	Qty
AL	Door with frame	61602353	900 x 1910 x 80	1
C9	Corner	61602148	1000 x 1910 x 80	4
D3	Side	61602132	300 x 1910 x 80	1
D6	Side	61602134	600 x 1910 x 80	3
D9	Side	61602135	900 x 1910 x 80	2
F9	Floor	61602423	2000 x 1300 x 80	2
T9	Ceiling	61602422	2000 x 1300 x 80	2

C10.3A/PM

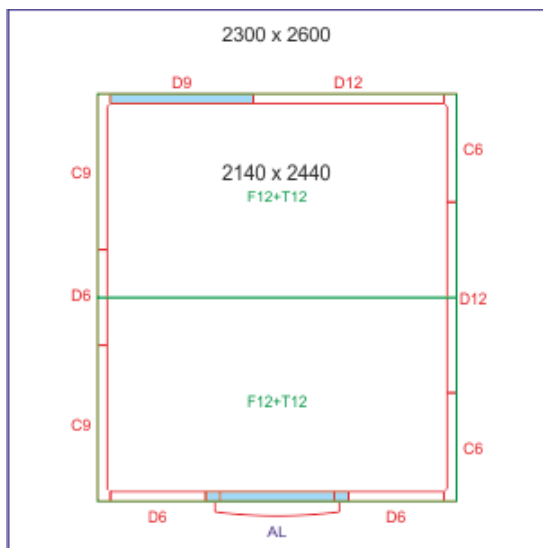

Panel ID				
Legend	Description	Prod. code	Dimensions	Qty
AL	Door with frame	61602353	900 x 1910 x 80	1
C6	Corner	61602146	700 x 1910 x 80	2
C9	Corner	61602148	1000 x 1910 x 80	2
D6	Side	61602134	600 x 1910 x 80	3
D9	Side	61602135	900 x 1910 x 80	1
D12	Side	61602136	1200 x 1910 x 80	2
F9	Floor	61602322	2300 x 1300 x 80	2
T9	Ceiling	61602248	2300 x 1300 x 80	2

PARTS LISTS / LISTES DES PIÈCES DÉTACHÉS / EINZELTEILLISTE

Minicold ISO
80

C11.8A/PM

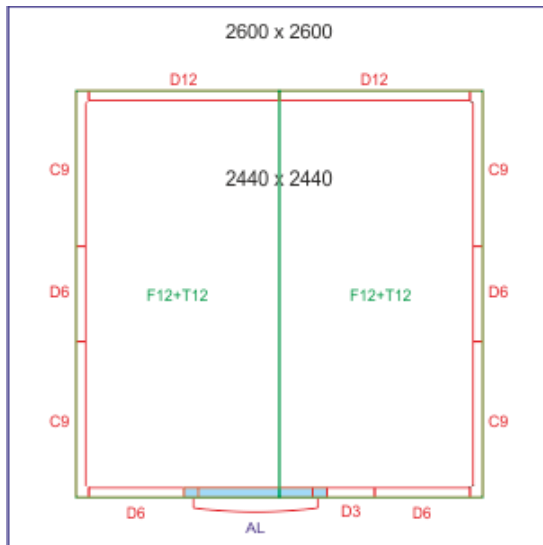

Panel ID				
Legend	Description	Prod. code	Dimensions	Qty
AL	Door with frame	61602353	900 x 1910 x 80	1
C9	Corner	61602148	1000 x 1910 x 80	4
D3	Side	61602132	300 x 1910 x 80	1
D6	Side	61602134	600 x 1910 x 80	4
D12	Side	61602136	1200 x 1910 x 80	2
F9	Floor	61602328	2600 x 1300 x 80	2
T9	Ceiling	61602251	2600 x 1300 x 80	2

C13.3A/PM

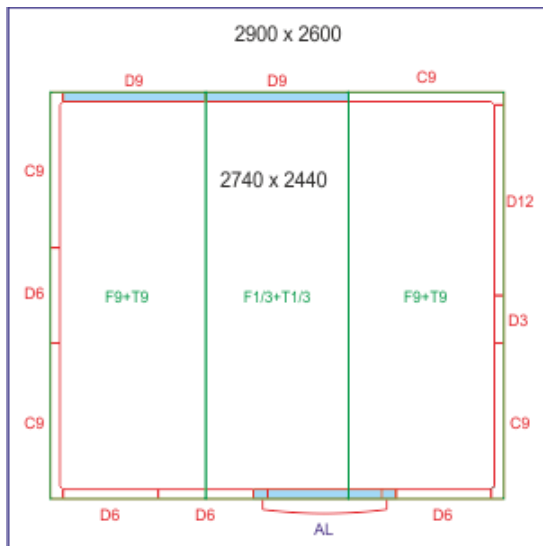

Panel ID				
Legend	Description	Prod. code	Dimensions	Qty
AL	Door with frame	61602353	900 x 1910 x 80	1
C9	Corner	61602148	1000 x 1910 x 80	4
D3	Side	61602132	300 x 1910 x 80	1
D6	Side	61602134	600 x 1910 x 80	4
D9	Side	61602135	900 x 1910 x 80	2
D12	Side	61602136	1200 x 1910 x 80	1
F9	Floor	61602250	2600 x 1000 x 80	2
F1/3	Floor	61602256	2600 x 1000 x 80	1
T9	Ceiling	61602327	2600 x 1000 x 80	2
T1/3	Ceiling	61602347	2600 x 1000 x 80	1