

03/2019

Mod: GFC-1N

Production code: GES 40

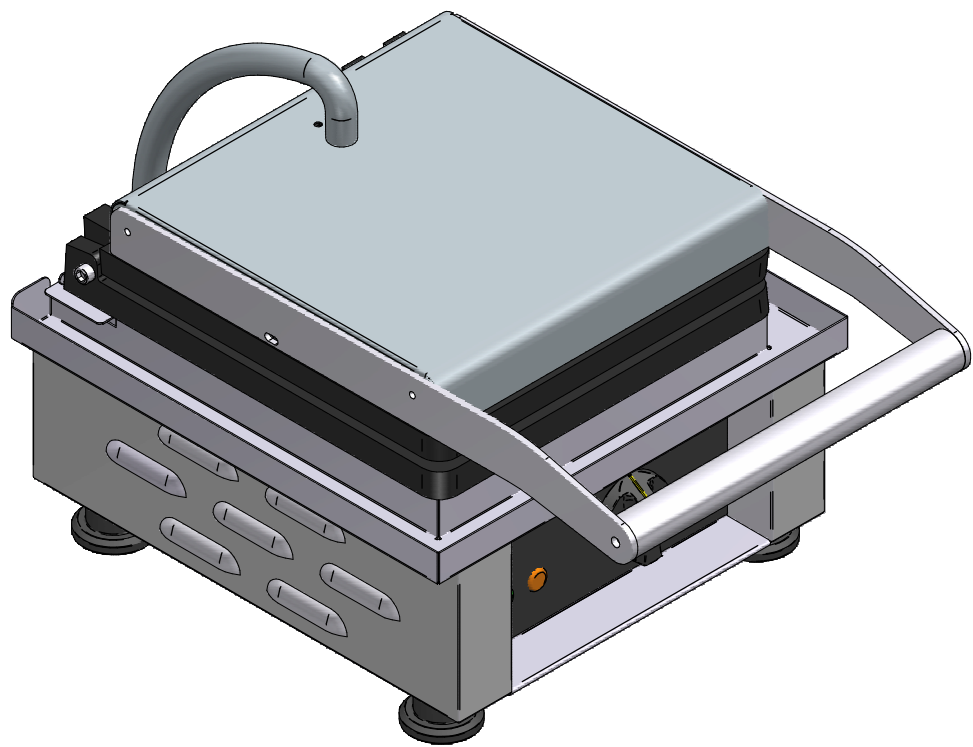

GES 10-20-40-60-80 B

Vue 3D

DT194

Date :
09/04/2018

Dessiné par :
R.L.

Approuvé par :
R.Schoenberger

Date :
09/04/2018

Indice
A

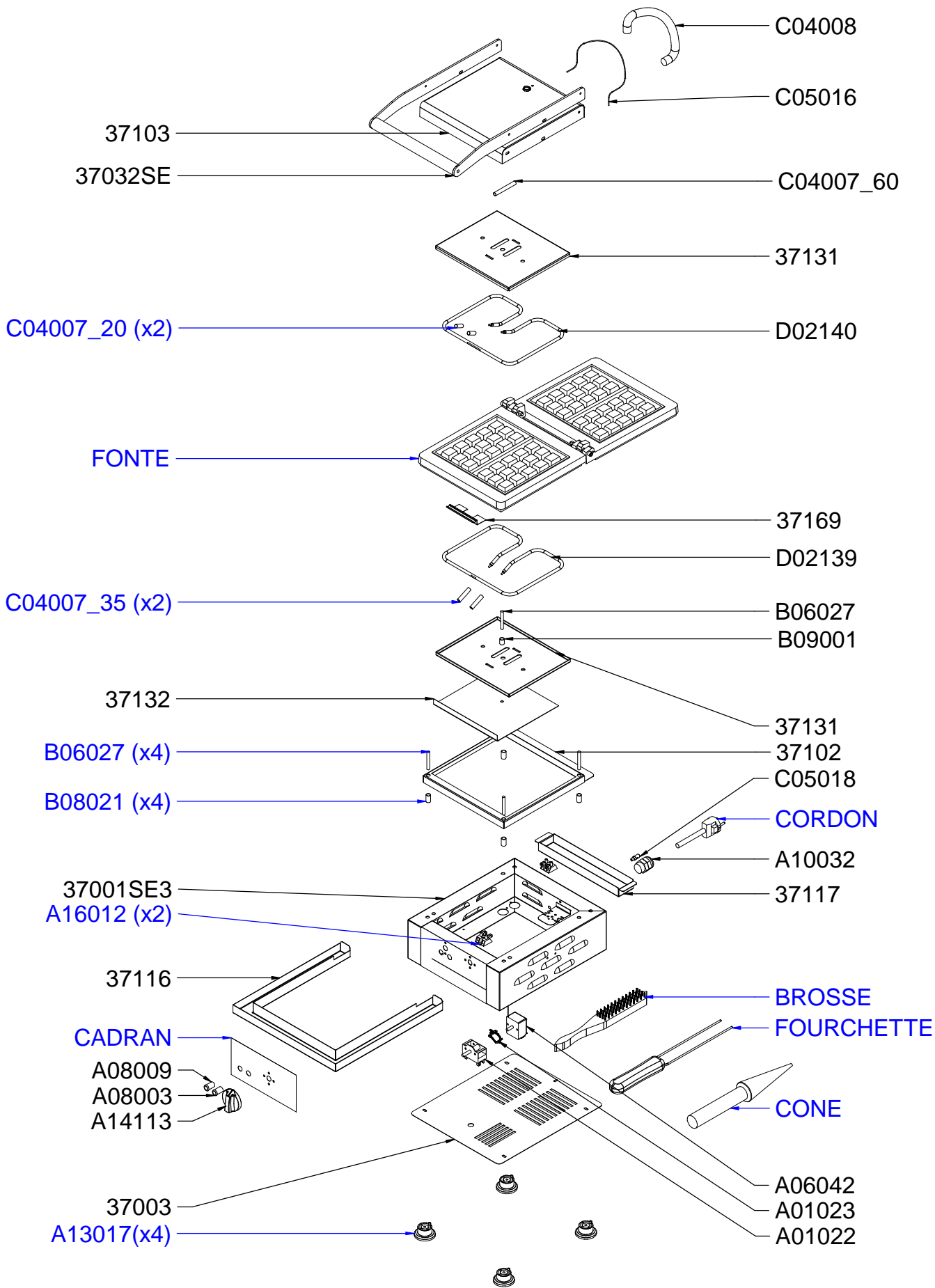

GES 10-20-40-60-80 B

Vue éclatée

DT194

Date :
09/04/2018

Dessiné par :
R.L.

Approuvé par :
S.Grenon

Date :
09/04/2018

Indice
A

| CODE | QTE | PIECE | SPARE PART |
|--------------------------|-----|---|-------------------------------------|
| 37001SE3 | 1 | S/E CEINTURE + BANDEAU SAVOYE B | ASSEMBLY OUTSIDE CASING SAVOYE B |
| 37003 | 1 | FOND DE SOCLE SAVOYE/GAUF SIMPLE | BOTTOM ENCLOSURE |
| 37032SE | 1 | S/E POIGNEE GAUCHE/DROIT GAUFRIER COMPLETE | HANDLE ASSEMBLY WAFFLE IRONS |
| 37102 | 1 | CADRE GAUFRIER SIMPLE | FRAME SIMPLE WAFFLE IRON |
| 37103 | 1 | CAPOT GAUFRIER | COVER WAFFLE IRON |
| 37116 | 1 | BAC A SAUCE AVANT GAUFRIER S | FRONT SAUCE LID SIMPLE WAFFLE IRON |
| 37117 | 1 | BAC A SAUCE ARRIERE GAUFRIER SIMPLE | BACK SAUCE LID SIMPLE WAFFLE IRON |
| 37131 | 2 | SERRE RESISTANCE CARREE GAUFRIER S/D | HEATING ELEMENT HOLDER |
| 37132 | 1 | PLAQUE ISOLATION GAUFRIER S/D | INSULATION PLATE WAFFLE IRON |
| 37169 | 1 | SERRE BULBE GAUFRIERS | BULB LOCK WAFFLE IRON |
| A01022 | 1 | COMMUTATEUR | COMMUTATOR |
| A01023 | 1 | CLIP D'ASSEMBLAGE | CLIP |
| A06042 | 1 | THERMOSTAT | THERMOSTAT |
| A08003 | 1 | VOYANT ORANGE DIAM 12 | ORANGE PILOT LIGHT DIAM 12 |
| A08009 | 1 | VOYANT VERT DIAM 12 | GREEN PILOT LIGHT DIAM 12 |
| A10032 | 1 | PRESSE ETOUPE | CORD CLOSER |
| A13017 | 4 | PIED | FOOT |
| A14113 | 1 | BOUTON ELEC PLAT 9 H | ELECTRIC KNOB 9 H |
| A16012 | 2 | BORNIER 2 PLOTS | 2 HOLES DOMINO |
| B06027 | 5 | BOUT FILETE M 6 x 40 | THREAD TIP M 6 x 40 |
| B08021 | 4 | ENTRETOISE ACIER CONTACT GRILL | STEEL SPACER |
| B09001 | 1 | ENTRETOISE DIAM EXT 10 LG 12 MM | SPACER DIAM EXT 10 LG 12 MM |
| CADRAN | 1 | CADRAN | FRONT PANEL |
| CORDON | 1 | CORDON | CORD |
| C04007_20 | 2 | SILIGAIN DIAM 8 mm | SHEATH DIM 8 mm |
| C04007_35 | 2 | SILIGAIN DIAM 8 mm | SHEATH DIM 8 mm |
| C04007_60 | 1 | SILIGAIN DIAM 8 mm | SHEATH DIM 8 mm |
| C04008 | 1 | GAIN RESSORT Lg 350 mm | SPRING GIRDLE Lg 350 mm |
| C05016 | 1 | FIL DE TERRE VERT/JAUNE | EARTH WIRE GREEN/YELLOW |
| C05018 | 1 | BORNE EQUIPOTENTIEL | EQUIPOTENTIAL TERMINAL |
| D02139 | 1 | RESISTANCE BLINDEE BASSE GAUFRIER | BOTTOM ARMOURED HEAT. ELEMENT |
| D02140 | 1 | RESISTANCE BLINDEE HAUTE GAUFRIER 800 W 240 V | TOP ARMOURED HEATING ELE. 800W 240V |
| SPECIFICITES / PRODUITS | | GES 10 / GES 20 / GES 40 / GES 60 / GES 80 | |
| FONTE / CAST IRON | 1 | B02029PTR / B02032 PTR / B02031PTR / B02032 PTR / B02051PTR | |
| FOURCHETTE / WAFFLE FORK | 1 | F03008COM / F03009COM / X / F03009COM / X | |
| CONE / ICE CREAM CONE | 1 | X / X / F05030 / X / X | |
| BROSSE / BRUSH | 1 | F05054 / F05054 / F05054 / F05054 / X | |

GES 10-20-40-60-80 B

Nomenclature

DT194

Date :
09/04/2018

Dessiné par :
R.L.

Approuvé par :
J.Godéré

Date :
09/04/2018

Indice
A