

06/2022

Mod: AP50M-1A

Production code: FAM006G001-DI

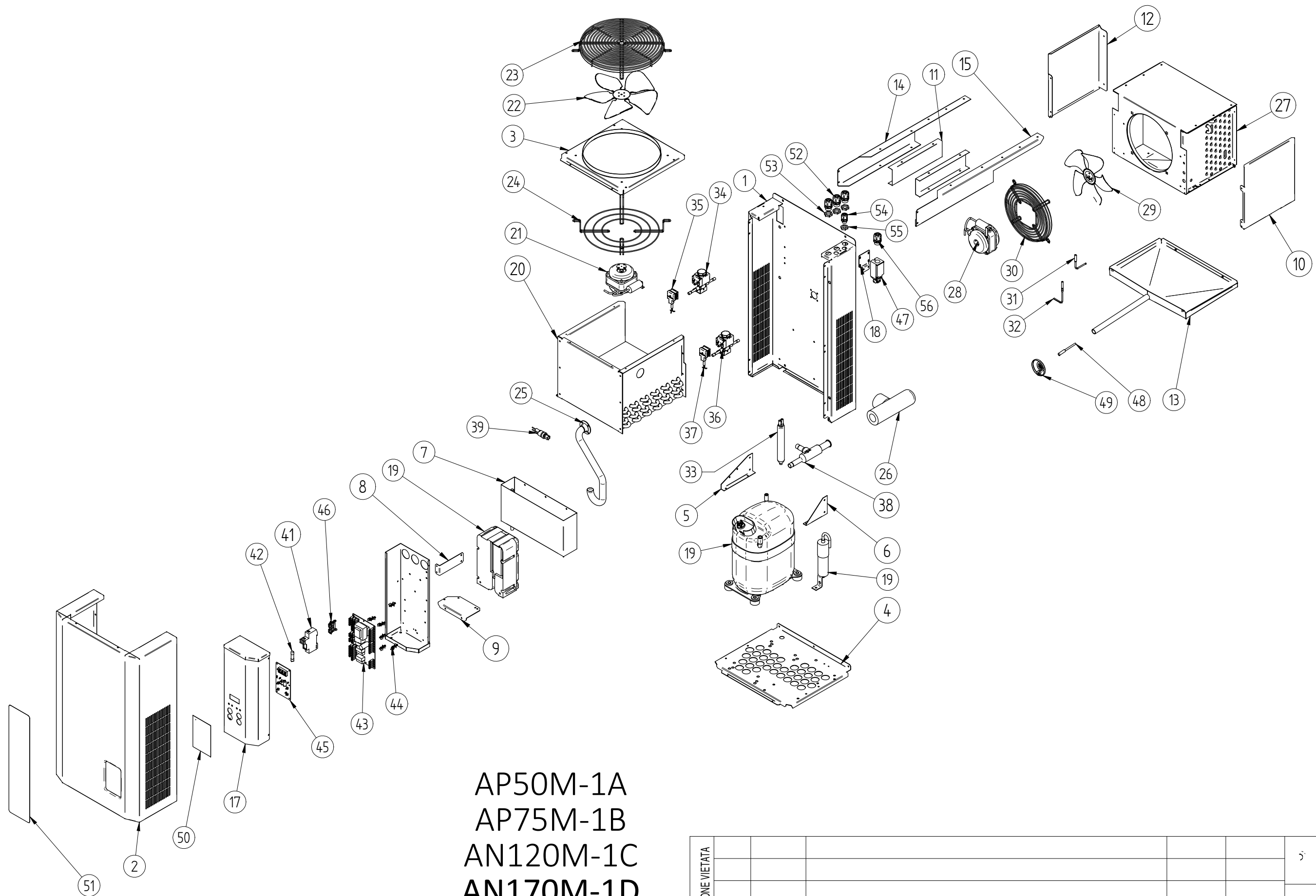

AP50M-1A
 AP75M-1B
 AN120M-1C
 AN170M-1D
 AN201M-1E

REV.		DATA	DESCRIZIONE REVISIONE				FIRMA	APPROVATO	
DISEGNATO:		APPROVATO:	DATA:	SCALA:	PESO:	FILE:	RIF. ESTERNO:		
MATERIALE:			CODICE GREZZO:			TOLLERANZE GENERALI:		NUM. INT. ESTERNO:	
RIVESTIMENTO SUPERFICIALE:			DENOMINAZIONE:			TAV:	TUBAZIONI: ±5mm. LAMIERE: ±1mm. (dim. lineari) POSIZIONI: ±1mm. CAVI: -10mm. +50mm. FORCINE: ±1mm. PACCO: -1mm. +0mm.		
MOD. 044 REV. 01 19/07/01		RIPRODUZIONE E/O DIFFUSIONE VIETATA		1 Di 1					

LISTA RICAMBI / SPARE PARTS LIST

Ref.	Descrizione/Description
19	Compressore/Compressor
20	Batteria del condensatore/Condenser coil
21	Motoventilatore del condensatore/Condenser fan motor
22	Ventola del condensatore/Condenser fan
23	Griglia esterna/External fan guard
24	Griglia interna/Internal fan guard
27	Batteria dell'evaporatore/Evaporator coil
28	Motoventilatore dell'evaporatore/Evaporator fan motor
48	Resistenza di scarico/Discharge electrical heater
13	Bacinella evaporatore/Evaporator drain pan
29	Ventola dell'evaporatore/Evaporator fan
30	Griglia interna/Internal fan guard
33	Filtro/Filter
36	Valvola solenoide linea liquido/Liquid line solenoid valve
34	Valvola solenoide sbrinamento gas caldo/Hot gas defrost solenoid valve
35	Connettore per solenoide/Solenoid valve connector
37	Connettore per solenoide/Solenoid valve connector
38	Valvola regolatrice di pressione/Regulating pressure valve
39	Pressostato HBP/HBP pressure switch
43	Scheda base/Main board
45	Tastiera/Keyboard
31	Sonda di temperatura cella/Cold room temperature probe
32	Sonda di fine sbrinamento/End defrost probe
44	Distanziali in plastica/Plastic board support
47	Interruttore micro porta/Door micro switch

LISTA RICAMBI / SPARE PARTS LIST

Ref.	DIAMOND MODEL	RANGE	COMPONENT	DESCRIPTION	Q.TY
19	AP50M-1A	FAM006G001-DI TN R452A 230/1/50	NEK6213GK-A-CSIR	COMP.ASPERA R404A 12,12CC V.220-240/1/50	1
20	AP50M-1A	FAM006G001-DI TN R452A 230/1/50	1250270P71	COND.C/PLENUM 42T 12T-5R-PACCO270-PA=2.5	1
21	AP50M-1A	FAM006G001-DI TN R452A 230/1/50	NET3C25PVN003	ELCO 25W V.230/50-60 VDE TIPO3 S/CAVO	1
22	AP50M-1A	FAM006G001-DI TN R452A 230/1/50	AO254-28	VENTOLA PREMENTE DIAM.254/28	1
23	AP50M-1A	FAM006G001-DI TN R452A 230/1/50	GI25046	GRIGLIA INTERNA D.250 H.46 VER.NERA	1
24	AP50M-1A	FAM006G001-DI TN R452A 230/1/50	G25029N	GRIGL.METALLO D.254 H.34 CHIUSA VER.NERA	1
27	AP50M-1A	FAM006G001-DI TN R452A 230/1/50	1060290N00	EVAP. 60T-10T-6R-290 PACCO-PA=5 FA1X250	1
28	AP50M-1A	FAM006G001-DI TN R452A 230/1/50	RET8T18PNN002	ELCO 18/62W 230/1/50-60 2600RPM C/COND.	1
48	AP50M-1A	FAM006G001-DI TN R452A 230/1/50	RES0500	RES. MONOUCITA IN GUAINA L=2900 15W	1
13	AP50M-1A	FAM006G001-DI TN R452A 230/1/50	92511174	AS.VASC.EVAP.C-TUBO L=260 FA1X250 (RV4)	1
29	AP50M-1A	FAM006G001-DI TN R452A 230/1/50	AO200-28	VENTOLA PREMENTE DIAM.200/28	1
30	AP50M-1A	FAM006G001-DI TN R452A 230/1/50	G20027	GRIGLIA IN METALLO D.200 APERTA	1
33	AP50M-1A	FAM006G001-DI TN R452A 230/1/50	GFN40_62-62_2V	FILTRO RAME G.40 XH9 6,2-6,2 C/2 VALV.	1
36					
34	AP50M-1A	FAM006G001-DI TN R452A 230/1/50	EVR3-32F1207	VALV.SOL.S/BOB.D06 ODF SALD.	1
35	AP50M-1A	FAM006G001-DI TN R452A 230/1/50	99100786	CONN.SOLENOIDE CABL.C/VITE 3G0,75X1000	1
37					
38					
39	AP50M-1A	FAM006G001-DI TN R452A 230/1/50	061F8175	MINIPRESS.ALTA R.AUT.28/23 PSH CAVO L=	1
43	AP50M-1A	FAM006G001-DI TN R452A 230/1/50	RIVB000001	BASE SCHEDA ELETTRONICA BLOCKSYSTEM	1
45	AP50M-1A	FAM006G001-DI TN R452A 230/1/50	RIVT000001	TASTIERA SCHEDA ELETTRONICA BLOCKSYSTEM	1
31	AP50M-1A	FAM006G001-DI TN R452A 230/1/50	7219-0013	SONDA NTC MEGATRON PVC.NERO.L=1,5M IP68	1
32	AP50M-1A	FAM006G001-DI TN R452A 230/1/50	7219-0018	SONDA NTC ACCIAIO L=1,5M D.TESTA=6MM	1
44	AP50M-1A	FAM006G001-DI TN R452A 230/1/50	99101003	DISTANZIALI IN PLASTICA X SCHEDA RIVB	6
47	AP50M-1A	FAM006G001-DI TN R452A 230/1/50	99103130	FINECORSA MICRO BLOCKSYS 1NC+1NO PIZZA	1

LISTA RICAMBI / SPARE PARTS LIST

Ref.	DIAMOND MODEL	RANGE	COMPONENT	DESCRIPTION	Q.TY
19	AP75M-1B	FAM009G001-DI TN R452A 230/1/50	NT6222GK-A-CSR	COMP.ASPERA R404A 17,4CC 220-240/50	1
20	AP75M-1B	FAM009G001-DI TN R452A 230/1/50	1250270P70	COND.C/PLENUM 60T-12T-5R-PACCO270-PA=2.5	1
21	AP75M-1B	FAM009G001-DI TN R452A 230/1/50	1BT35-25-1VNO	ELCO 35W V.230/50-60 TIPO 2 S/CAVO	1
22	AP75M-1B	FAM009G001-DI TN R452A 230/1/50	AO254-34	VENTOLA PREMENTE DIAM.254/34	1
23	AP75M-1B	FAM009G001-DI TN R452A 230/1/50	GI25046	GRIGLIA INTERNA D.250 H.46 VER.NERA	1
24	AP75M-1B	FAM009G001-DI TN R452A 230/1/50	G25029N	GRIGL.METALLO D.254 H.34 CHIUSA VER.NERA	1
27	AP75M-1B	FAM009G001-DI TN R452A 230/1/50	1080290N00	EVAP. 80T-10T-8R-290 PACCO-PA=5 FA1X250	1
28	AP75M-1B	FAM009G001-DI TN R452A 230/1/50	RET8T18PNN002	ELCO 18/62W 230/1/50-60 2600RPM C/COND.	1
48	AP75M-1B	FAM009G001-DI TN R452A 230/1/50	RES0500	RES. MONOUCITA IN GUAINA L=2900 15W	1
13	AP75M-1B	FAM009G001-DI TN R452A 230/1/50	92511174	AS.VASC.EVAP.C-TUBO L=260 FA1X250 (RV4)	1
29	AP75M-1B	FAM009G001-DI TN R452A 230/1/50	AO200-28	VENTOLA PREMENTE DIAM.200/28	1
30	AP75M-1B	FAM009G001-DI TN R452A 230/1/50	G20027	GRIGLIA IN METALLO D.200 APERTA	1
33	AP75M-1B	FAM009G001-DI TN R452A 230/1/50	GFN40_62-62_2V	FILTRO RAME G.40 XH9 6,2-6,2 C/2 VALV.	1
36					
34	AP75M-1B	FAM009G001-DI TN R452A 230/1/50	EVR3-32F1207	VALV.SOL.S/BOB.D06 ODF SALD.	1
35	AP75M-1B	FAM009G001-DI TN R452A 230/1/50	99100786	CONN.SOLENOIDE CABL.C/VITE 3G0,75X1000	1
37					
38					
39	AP75M-1B	FAM009G001-DI TN R452A 230/1/50	061F8175	MINIPRESS.ALTA R.AUT.28/23 PSH CAVO L=	1
43	AP75M-1B	FAM009G001-DI TN R452A 230/1/50	RIVB000001	BASE SCHEDA ELETTRONICA BLOCKSYSTEM	1
45	AP75M-1B	FAM009G001-DI TN R452A 230/1/50	RIVT000001	TASTIERA SCHEDA ELETTRONICA BLOCKSYSTEM	1
31	AP75M-1B	FAM009G001-DI TN R452A 230/1/50	7219-0013	SONDA NTC MEGATRON PVC.NERO.L=1,5M IP68	1
32	AP75M-1B	FAM009G001-DI TN R452A 230/1/50	7219-0018	SONDA NTC ACCIAIO L=1,5M D.TESTA=6MM	1
44	AP75M-1B	FAM009G001-DI TN R452A 230/1/50	99101003	DISTANZIALI IN PLASTICA X SCHEDA RIVB	6
47	AP75M-1B	FAM009G001-DI TN R452A 230/1/50	99103130	FINECORSA MICRO BLOCKSYS 1NC+1NO PIZZA	1

LISTA RICAMBI / SPARE PARTS LIST

Ref.	DIAMOND MODEL	RANGE	COMPONENT	DESCRIPTION	Q.TY
19	AN120M-1C	FAL003G011-DI BT R452A 230/1/50	NEU2178GK-A-CSR	COMP.ASPERA R404A 16,8CC V.220-24	1
20	AN120M-1C	FAL003G011-DI BT R452A 230/1/50	1240270P71	COND.C/PLENUM 36T 12T-4R-PACCO270-PA=2,5	1
21	AN120M-1C	FAL003G011-DI BT R452A 230/1/50	NET3C25PVN003	ELCO 25W V.230/50-60 VDE TIPO3 S/CAVO	1
22	AN120M-1C	FAL003G011-DI BT R452A 230/1/50	AO254-28	VENTOLA PREMENTE DIAM.254/28	1
23	AN120M-1C	FAL003G011-DI BT R452A 230/1/50	GI25046	GRIGLIA INTERNA D.250 H.46 VER.NERA	1
24	AN120M-1C	FAL003G011-DI BT R452A 230/1/50	G25029N	GRIGL.METALLO D.254 H.34 CHIUSA VER.NERA	1
27	AN120M-1C	FAL003G011-DI BT R452A 230/1/50	1060290N00	EVAP. 60T-10T-6R-290 PACCO-PA=5 FA1X250	1
28	AN120M-1C	FAL003G011-DI BT R452A 230/1/50	RET8T18PNN002	ELCO 18/62W 230/1/50-60 2600RPM C/COND.	1
48	AN120M-1C	FAL003G011-DI BT R452A 230/1/50	RES0500	RES. MONOUSCITA IN GUAINA L=2900 15W	1
13	AN120M-1C	FAL003G011-DI BT R452A 230/1/50	92511174	AS.VASC.EVAP.C-TUBO L=260 FA1X250 (RV4)	1
29	AN120M-1C	FAL003G011-DI BT R452A 230/1/50	AO200-28	VENTOLA PREMENTE DIAM.200/28	1
30	AN120M-1C	FAL003G011-DI BT R452A 230/1/50	G20027	GRIGLIA IN METALLO D.200 APERTA	1
33	AN120M-1C	FAL003G011-DI BT R452A 230/1/50	GFN40_62-62_2V	FILTRO RAME G.40 XH9 6,2-6,2 C/2 VALV.	1
36	AN120M-1C	FAL003G011-DI BT R452A 230/1/50	1028/X04A6	VALV.SOL.X FREON C/B. A SAL.D 6	1
34	AN120M-1C	FAL003G011-DI BT R452A 230/1/50	1028/X04A6	VALV.SOL.X FREON C/B. A SAL.D 6	1
35	AN120M-1C	FAL003G011-DI BT R452A 230/1/50	99100786	CONN.SOLENOIDE CABL.C/VITE 3G0,75X1000	1
37	AN120M-1C	FAL003G011-DI BT R452A 230/1/50	99100787	CONN.SOLENOIDE CABL.C/VITE 3G0,75X2000	1
38	AN120M-1C	FAL003G011-DI BT R452A 230/1/50	KVL12	VAL. REG. PRESS. ASP. 1/2 SALDARE	1
39	AN120M-1C	FAL003G011-DI BT R452A 230/1/50	061F8175	MINIPRESS.ALTA R.AUT.28/23 PSH CAVO L=	1
43	AN120M-1C	FAL003G011-DI BT R452A 230/1/50	RIVB000001	BASE SCHEDA ELETTRONICA BLOCKSYSTEM	1
45	AN120M-1C	FAL003G011-DI BT R452A 230/1/50	RIVT000001	TASTIERA SCHEDA ELETTRONICA BLOCKSYSTEM	1
31	AN120M-1C	FAL003G011-DI BT R452A 230/1/50	7219-0013	SONDA NTC MEGATRON PVC.NERO.L=1,5M IP68	1
32	AN120M-1C	FAL003G011-DI BT R452A 230/1/50	7219-0018	SONDA NTC ACCIAIO L=1,5M D.TESTA=6MM	1
44	AN120M-1C	FAL003G011-DI BT R452A 230/1/50	99101003	DISTANZIALI IN PLASTICA X SCHEDA RIVB	6
47	AN120M-1C	FAL003G011-DI BT R452A 230/1/50	99103130	FINECORSA MICRO BLOCKSYS 1NC+1NO PIZZA	1

LISTA RICAMBI / SPARE PARTS LIST

Ref.	DIAMOND MODEL	RANGE	COMPONENT	DESCRIPTION	Q.TY
19	AN170M-1D	FAL006G011-DI BT R452A 230/1/50	NJ2192GJ-A-CSR	COMP.EMBRACO R404A 26,0CC 220-240/50	1
20	AN170M-1D	FAL006G011-DI BT R452A 230/1/50	1250270P70	COND.C/PLENUM 60T-12T-5R-PACCO270-PA=2.5	1
21	AN170M-1D	FAL006G011-DI BT R452A 230/1/50	1BT35-25-1VNO	ELCO 35W V.230/50-60 TIPO 2 S/CAVO	1
22	AN170M-1D	FAL006G011-DI BT R452A 230/1/50	AO254-34	VENTOLA PREMENTE DIAM.254/34	1
23	AN170M-1D	FAL006G011-DI BT R452A 230/1/50	GI25046	GRIGLIA INTERNA D.250 H.46 VER.NERA	1
24	AN170M-1D	FAL006G011-DI BT R452A 230/1/50	G25029N	GRIGL.METALLO D.254 H.34 CHIUSA VER.NERA	1
27	AN170M-1D	FAL006G011-DI BT R452A 230/1/50	1080290N00	EVAP. 80T-10T-8R-290 PACCO-PA=5 FA1X250	1
28	AN170M-1D	FAL006G011-DI BT R452A 230/1/50	RET8T18PNN002	ELCO 18/62W 230/1/50-60 2600RPM C/COND.	1
48	AN170M-1D	FAL006G011-DI BT R452A 230/1/50	RES0500	RES. MONOUCITA IN GUAINA L=2900 15W	1
13	AN170M-1D	FAL006G011-DI BT R452A 230/1/50	92511174	AS.VASC.EVAP.C-TUBO L=260 FA1X250 (RV4)	1
29	AN170M-1D	FAL006G011-DI BT R452A 230/1/50	AO200-28	VENTOLA PREMENTE DIAM.200/28	1
30	AN170M-1D	FAL006G011-DI BT R452A 230/1/50	G20027	GRIGLIA IN METALLO D.200 APERTA	1
33	AN170M-1D	FAL006G011-DI BT R452A 230/1/50	GFN40_62-62_2V	FILTRO RAME G.40 XH9 6,2-6,2 C/2 VALV.	1
36	AN170M-1D	FAL006G011-DI BT R452A 230/1/50	1028/X04A6	VALV.SOL.X FREON C/B. A SAL.D 6	1
34	AN170M-1D	FAL006G011-DI BT R452A 230/1/50	1028/X04A6	VALV.SOL.X FREON C/B. A SAL.D 6	1
35	AN170M-1D	FAL006G011-DI BT R452A 230/1/50	99100786	CONN.SOLENOIDE CABL.C/VITE 3G0,75X1000	1
37	AN170M-1D	FAL006G011-DI BT R452A 230/1/50	99100787	CONN.SOLENOIDE CABL.C/VITE 3G0,75X2000	1
38	AN170M-1D	FAL006G011-DI BT R452A 230/1/50	KVL12	VAL. REG. PRESS. ASP. 1/2 SALDARE	1
39	AN170M-1D	FAL006G011-DI BT R452A 230/1/50	061F8175	MINIPRESS.ALTA R.AUT.28/23 PSH CAVO L=	1
43	AN170M-1D	FAL006G011-DI BT R452A 230/1/50	RIVB000001	BASE SCHEDA ELETTRONICA BLOCKSYSTEM	1
45	AN170M-1D	FAL006G011-DI BT R452A 230/1/50	RIVT000001	TASTIERA SCHEDA ELETTRONICA BLOCKSYSTEM	1
31	AN170M-1D	FAL006G011-DI BT R452A 230/1/50	7219-0013	SONDA NTC MEGATRON PVC.NERO.L=1,5M IP68	1
32	AN170M-1D	FAL006G011-DI BT R452A 230/1/50	7219-0018	SONDA NTC ACCIAIO L=1,5M D.TESTA=6MM	1
44	AN170M-1D	FAL006G011-DI BT R452A 230/1/50	99101003	DISTANZIALI IN PLASTICA X SCHEDA RIVB	6
47	AN170M-1D	FAL006G011-DI BT R452A 230/1/50	99103130	FINECORSA MICRO BLOCKSYS 1NC+1NO PIZZA	1

LISTA RICAMBI / SPARE PARTS LIST

Ref.	DIAMOND MODEL	RANGE	COMPONENT	DESCRIPTION	Q.TY
19	AN201M-1E	FAL009G011-DI BT R452A 230/1/50	NJ2212GK-A-CSR	COMP.ASPERA R404 34,3CC 220-240/50	1
20	AN201M-1E	FAL009G011-DI BT R452A 230/1/50	1250270PD0	COND.C/PLENUM 60T-12T-5R-270-PA2.5 T.R.	1
21	AN201M-1E	FAL009G011-DI BT R452A 230/1/50	1BT35-25-1VNO	ELCO 35W V.230/50-60 TIPO 2 S/CAVO	1
22	AN201M-1E	FAL009G011-DI BT R452A 230/1/50	AO254-34	VENTOLA PREMENTE DIAM.254/34	1
23	AN201M-1E	FAL009G011-DI BT R452A 230/1/50	GI25046	GRIGLIA INTERNA D.250 H.46 VER.NERA	1
24	AN201M-1E	FAL009G011-DI BT R452A 230/1/50	G25029N	GRIGL.METALLO D.254 H.34 CHIUSA VER.NERA	1
27	AN201M-1E	FAL009G011-DI BT R452A 230/1/50	1080290N00	EVAP. 80T-10T-8R-290 PACCO-PA=5 FA1X250	1
28	AN201M-1E	FAL009G011-DI BT R452A 230/1/50	RET8T18PNN002	ELCO 18/62W 230/1/50-60 2600RPM C/COND.	1
48	AN201M-1E	FAL009G011-DI BT R452A 230/1/50	RES0500	RES. MONOUSCITA IN GUAINA L=2900 15W	1
13	AN201M-1E	FAL009G011-DI BT R452A 230/1/50	92511174	AS.VASC.EVAP.C-TUBO L=260 FA1X250 (RV4)	1
29	AN201M-1E	FAL009G011-DI BT R452A 230/1/50	AO200-28	VENTOLA PREMENTE DIAM.200/28	1
30	AN201M-1E	FAL009G011-DI BT R452A 230/1/50	G20027	GRIGLIA IN METALLO D.200 APERTA	1
33	AN201M-1E	FAL009G011-DI BT R452A 230/1/50	GFN40_62-62_2V	FILTRO RAME G.40 XH9 6,2-6,2 C/2 VALV.	1
36	AN201M-1E	FAL009G011-DI BT R452A 230/1/50	1028/X04A6	VALV.SOL.X FREON C/B. A SAL.D 6	1
34	AN201M-1E	FAL009G011-DI BT R452A 230/1/50	1028/X04A6	VALV.SOL.X FREON C/B. A SAL.D 6	1
35	AN201M-1E	FAL009G011-DI BT R452A 230/1/50	99100786	CONN.SOLENOIDE CABL.C/VITE 3G0,75X1000	1
37	AN201M-1E	FAL009G011-DI BT R452A 230/1/50	99100787	CONN.SOLENOIDE CABL.C/VITE 3G0,75X2000	1
38	AN201M-1E	FAL009G011-DI BT R452A 230/1/50	KVL12	VAL. REG. PRESS. ASP. 1/2 SALDARE	1
39	AN201M-1E	FAL009G011-DI BT R452A 230/1/50	061F8175	MINIPRESS.ALTA R.AUT.28/23 PSH CAVO L=	1
43	AN201M-1E	FAL009G011-DI BT R452A 230/1/50	RIVB000001	BASE SCHEDA ELETTRONICA BLOCKSYSTEM	1
45	AN201M-1E	FAL009G011-DI BT R452A 230/1/50	RIVT000001	TASTIERA SCHEDA ELETTRONICA BLOCKSYSTEM	1
31	AN201M-1E	FAL009G011-DI BT R452A 230/1/50	7219-0013	SONDA NTC MEGATRON PVC.NERO.L=1,5M IP68	1
32	AN201M-1E	FAL009G011-DI BT R452A 230/1/50	7219-0018	SONDA NTC ACCIAIO L=1,5M D.TESTA=6MM	1
44	AN201M-1E	FAL009G011-DI BT R452A 230/1/50	99101003	DISTANZIALI IN PLASTICA X SCHEDA RIVB	6
47	AN201M-1E	FAL009G011-DI BT R452A 230/1/50	99103130	FINECORSA MICRO BLOCKSYS 1NC+1NO PIZZA	1