

02/2015

Mod: DRINK-38/SE

Production code: CEV425



Diamond
catering equipment

CEV425

10-02-2015

| POS. | PART NO | ITEM | EUR | DKK |
|-------------|----------------|--|------------|------------|
| 1 | 1010708371 | DOOR BLACK FRAME INT. HANDLE | | |
| 1 | 1010708372 | DOOR BLACK FRAME EXT. HANDLE | | |
| 1.1 | 2014690016 | DOOR GASKET, BLACK | | |
| 1.2 | 1024900002 | LOCK WITH KEY | | |
| 2 | 1414618082 | HANDLE, BLACK (INTEGRATED) | | |
| 2.1 | 1115200271 | CURVED HANDLE (2011) | | |
| 4 | 1011910004 | BASE FOR HINGE, RIGHT TOP | | |
| 5 | 1011910003 | TOP HINGE PIN | | |
| 6 | 1011908042 | BOTTOM HINGE | | |
| 6.1 | 1017640010 | PIN FOR BOTTOM HINGE | | |
| 6.2 | 1014618021 | PLASTIC UNDER THE BOTTOM HINGE | | |
| 7 | 1014618029 | FALSE BOTTOM HINGE | | |
| 8 | 1014618072 | CONTROL PANEL, SCU | | |
| 9.1 | 2014618067 | COVER FOR THERMOMETER, SCU PANEL | | |
| 9.2 | 2014618069 | COVER FOR SCREW, SCU PANEL | | |
| 9.4 | 2014618070 | COVER FOR SWITCH, SCU PANEL | | |
| 10 | 1022600059 | THERMOSTAT K50-L3420 500 MM | | |
| 11 | 1014618066 | THERMOSTAT KNOB, SCU | | |
| 12 | 1014610100 | FIXING CLAMP FOR CONDENSER | | |
| 13 | 1024100002 | THERMOMETER, BLACK | | |
| 14 | 1013916017 | GREEN CONTROL LAMP | | |
| 15 | 1013916016 | SWITCH FOR LIGHT | | |
| 16 | 1013912001 | STARTER 4-22 | | |
| 17 | 1013912005 | SOCKET FOR STARTER | | |
| 18 | 1014618052 | BUSHING | | |
| 19 | 1013980001 | BALLAST 15 W | | |
| 20 | 1013700228 | INTERNAL FAN MOTOR | | |
| 21 | 2014611085 | COVER FOR INTERNAL FAN | | |
| 22 | 1013920001 | FLUORESCENT TUBE 15W | | |
| 23 | 1022700002 | ROLL BOND EVAPORATOR, WHITE | | |
| 24 | 1015200151 | WIRE SHELF FOR PRINT | | |
| 25 | 1014618053 | VENTILATION GRILL BOTTOM, BLACK | | |
| 26 | 1014618055 | PLASTIC SCREW COVER FOR FRONT GRILL | | |
| 27 | 1014611128 | PLASTIC HOLDER FOR CONDENSER | | |
| 28 | 1012800042 | CONDENSER | | |
| 30 | 1013000015 | DRIER 3/16 20 GR | | |
| 31 | 1014610174 | DRIP TRAY | | |
| 32 | 1014610190 | ADJUSTMENT SCREW FOOT | | |
| 33 | 1014610071 | ROLLER | | |
| 36.1 | 1013940002 | SOCKET FOR FLUORESCENT TUBE | | |
| 36.2 | 1014630216 | COVER FOR FLUORESCENT TUBE | | |
| 36.3 | 3914630215 | PLASTIC CAP FOR FLUORESCENT TUBE | | |
| 36.4 | 1014611087 | PLASTIC HOLDER FOR FLUORESCENT TUBE | | |
| 37 | 1017550001 | COVER FOR BALLAST | | |
| 38 | 1515200101 | GRILL COVER FOR COMPRESSOR COMPARTMENT | | |
| 40 | 2622400215 | COMPRESSOR COMPLETE EMT45HDR | | |
| 44 | 1014680046 | DRAIN PIPE | | |
| 50 | 1011800087 | PIN FOR ROLLER | | |

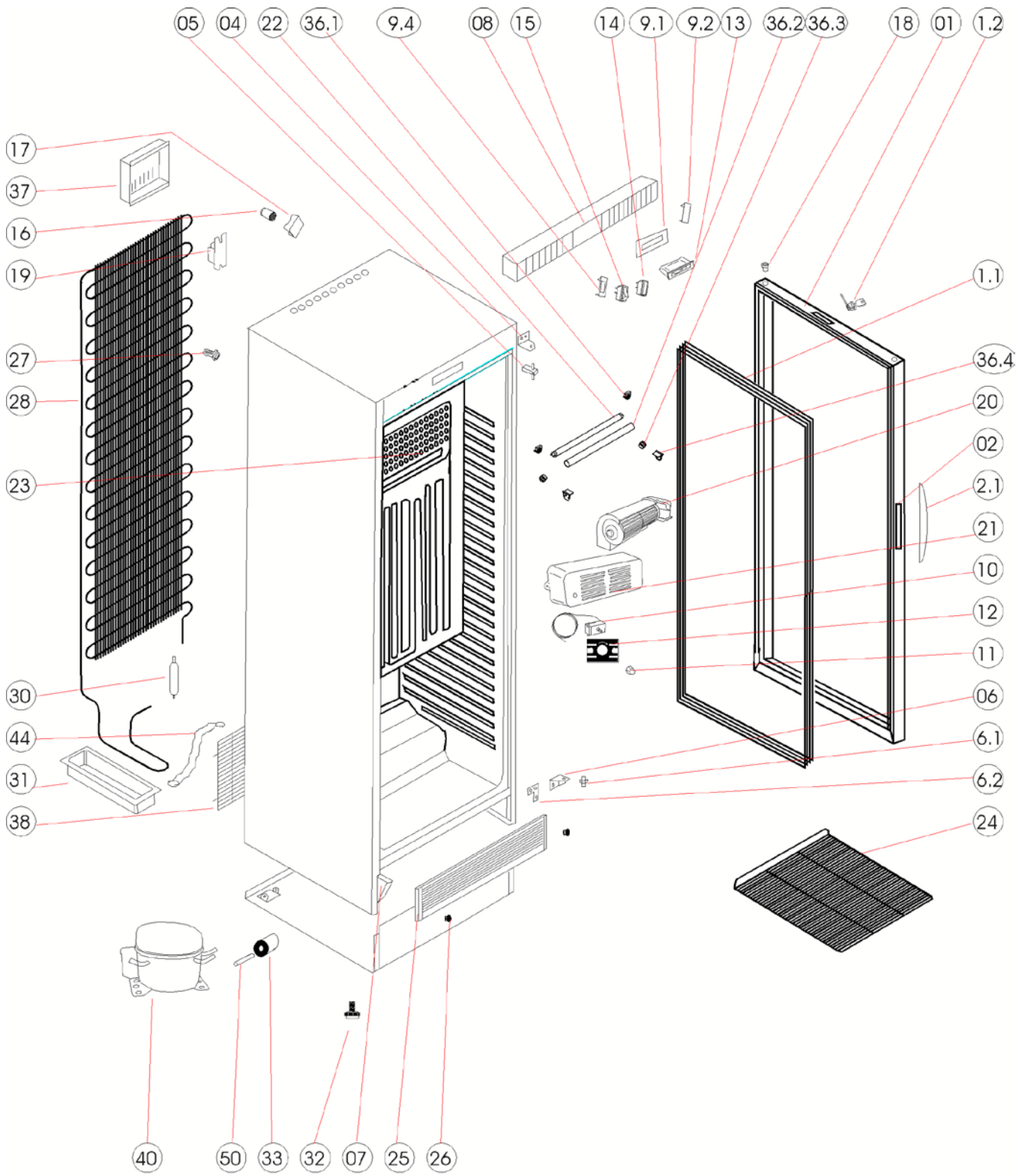

110729

Explode CEV425